

---

# STATES OF JERSEY



## LAND TRANSACTIONS UNDER STANDING ORDER 168(3) –

- (a) LA COLLETTE SITES LC08, LC09, LC22A AND F24 – PROPOSED LEASE TO PORTS OF JERSEY LTD.;
- (b) LAND UPON WHICH THE JERSEY SPARTAN ATHLETIC CLUBHOUSE HAS BEEN CONSTRUCTED AT F.B. FIELDS, LA GRANDE ROUTE DE ST. CLEMENT, ST. CLEMENT – LEASE;
- (c) ACQUISITION OF LAND AT ROCQUE BAY APARTMENTS, LA GRANDE ROUTE DE LA CÔTE, ST. CLEMENT.

---

Presented to the States on 22nd October 2018  
by the Minister for Infrastructure

---

STATES GREFFE

## REPORT

**Decision(s):** Under Standing Order 168(3), the Minister for Infrastructure hereby notifies the States that he has accepted the recommendation of Jersey Property Holdings to agree to the following –

**(a) Land transaction –**

To transfer to Ports of Jersey Ltd. the La Collette Sites LC08, LC09, LC22A and F24 in accordance with the agreement made between the Treasurer of the States and the CEO of Ports of Jersey Ltd. on 26 March 2018 – the transfer being by way of an addendum to the 2015 “Ports Lease”.

The Minister hereby authorises, as applicable, the Attorney General and the Greffier of the States to pass any contract which is required to be passed on behalf of the Public; and the Director of Property Holdings to conclude any contract which is required to be concluded on behalf of the Public.

After the expiry of 15 days following presentation to the States the transaction may be concluded.

*(Drawings are attached at Appendix 1.)*

*Further information on this decision can be found on [www.gov.je](http://www.gov.je) under Ministerial Decisions (reference MD-PH-2018-0036).*

**(b) Land transaction –**

To grant a 25-year lease to the existing tenant, the Jersey Spartan Athletic Club, under the terms and conditions set out in the report accompanying the Ministerial Decision.

The Minister hereby authorises, as applicable, the Attorney General and the Greffier of the States to pass any contract which is required to be passed on behalf of the Public; and the Director of Property Holdings to conclude any contract which is required to be concluded on behalf of the Public.

After the expiry of 15 days following presentation to the States the transaction may be concluded.

*(Drawing attached at Appendix 2.)*

*Further information on this decision can be found on [www.gov.je](http://www.gov.je) under Ministerial Decisions (reference MD-PH-2018-0048).*

(c) **Land transaction –**

1. The acquisition of a strip of land now made up as a pedestrian footway forming the southern limit of the new development known as “Rocque Bay Apartments” (formerly “The Shakespeare Hotel”), the land to be incorporated into the main road, “La Grande Route de la Côte”.
2. To confirm in the same contract the boundary between the property known as “Jocelyn” and the strip of land.

The Minister hereby authorises, as applicable, the Attorney General and the Greffier of the States to pass any contract which is required to be passed on behalf of the Public; and the Director of Property Holdings to conclude any contract which is required to be concluded on behalf of the Public.

After the expiry of 15 days following presentation to the States the transaction may be concluded.

*(Drawings are attached at Appendix 3.)*

*Further information on this decision can be found on [www.gov.je](http://www.gov.je) under Ministerial Decisions (reference MD-PH-2018-0050).*

APPENDIX 1

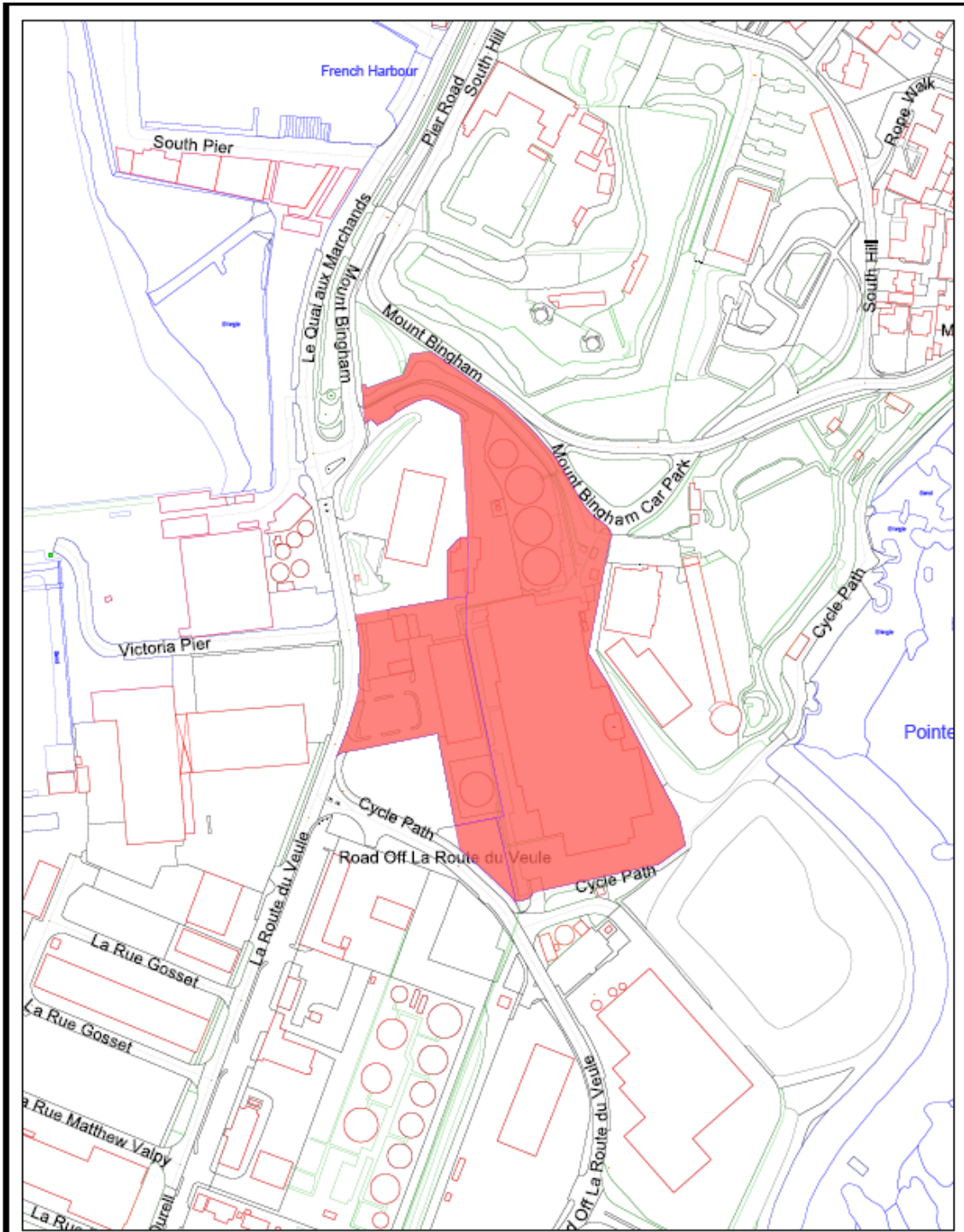

La Collette Sites LC 08, 09, 22a & F24

Drawing No: 1662 D1

Boundary Information Supplied by the States of Jersey Planning Office, but no responsibility can be accepted for error.



COPYRIGHT  
STATES OF JERSEY

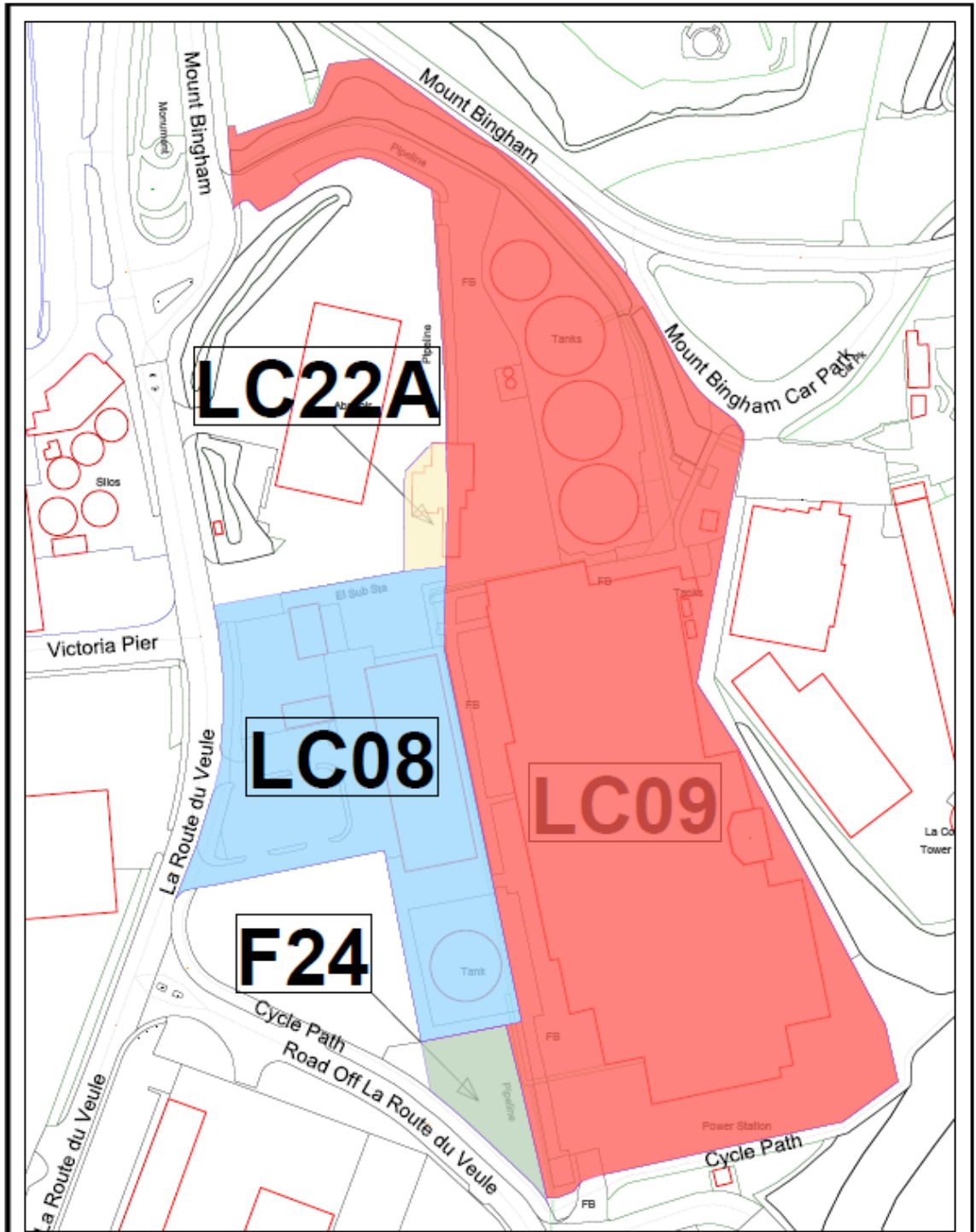

|  |  |
|--|--|
| <p>La Collette Sites LC08, 09, 22A &amp; F24</p>   | <p>Drawing No: 1662 D2</p>   |
| <p>Boundary Information Supplied by the States of Jersey Planning Office, but no responsibility can be accepted for error.</p> | <p> <b>COPYRIGHT STATES OF JERSEY</b></p> |

APPENDIX 2

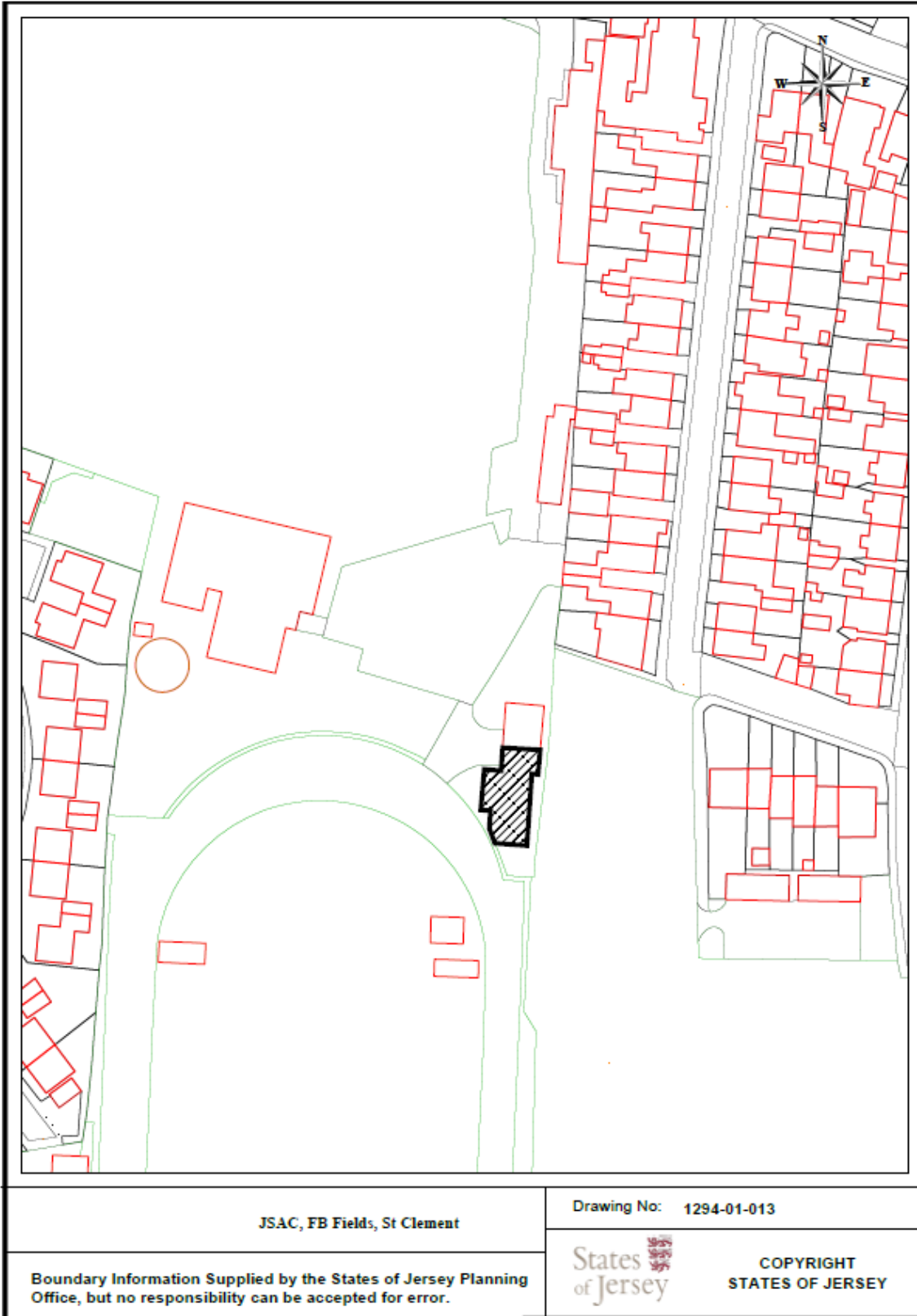

APPENDIX 3

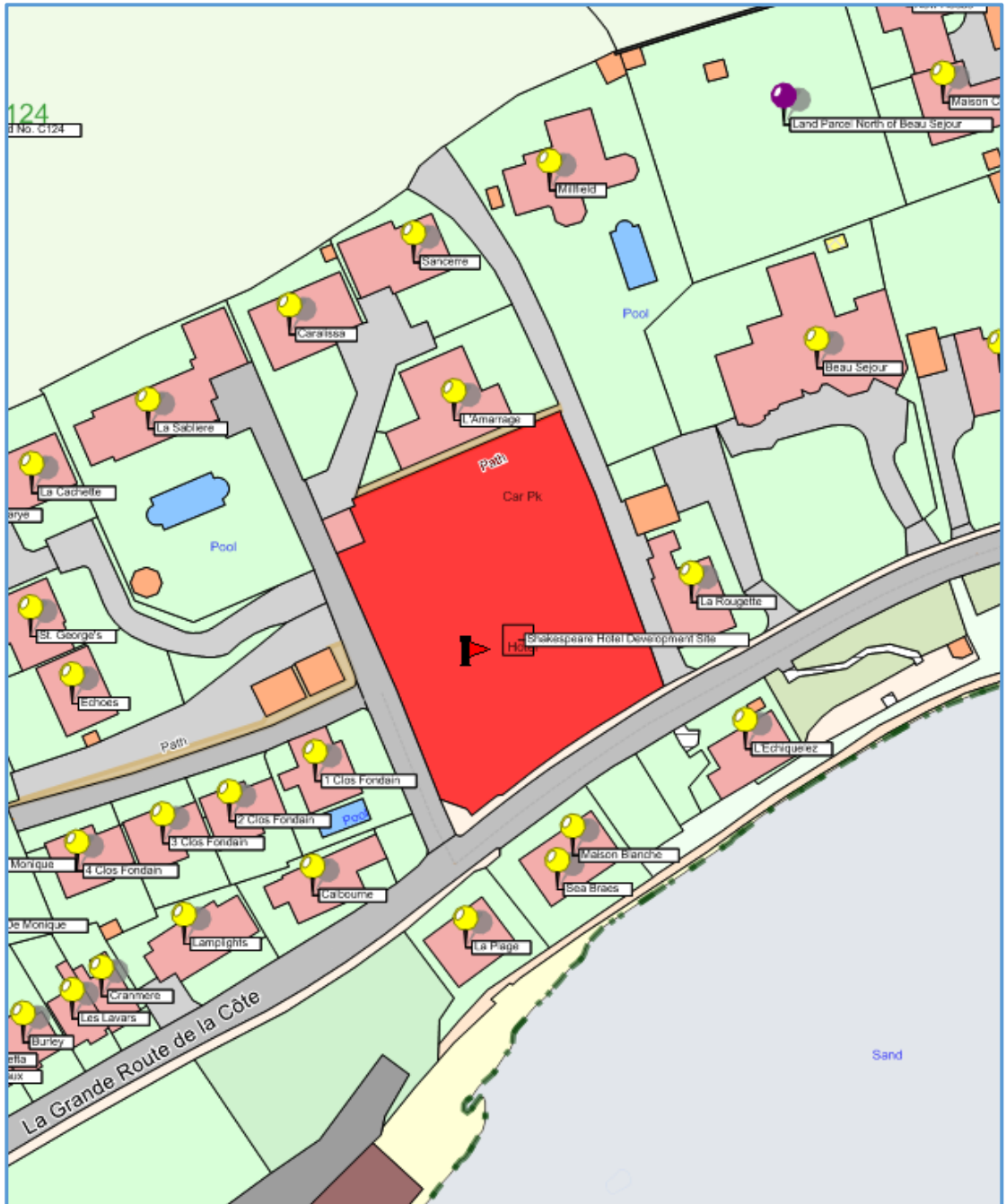

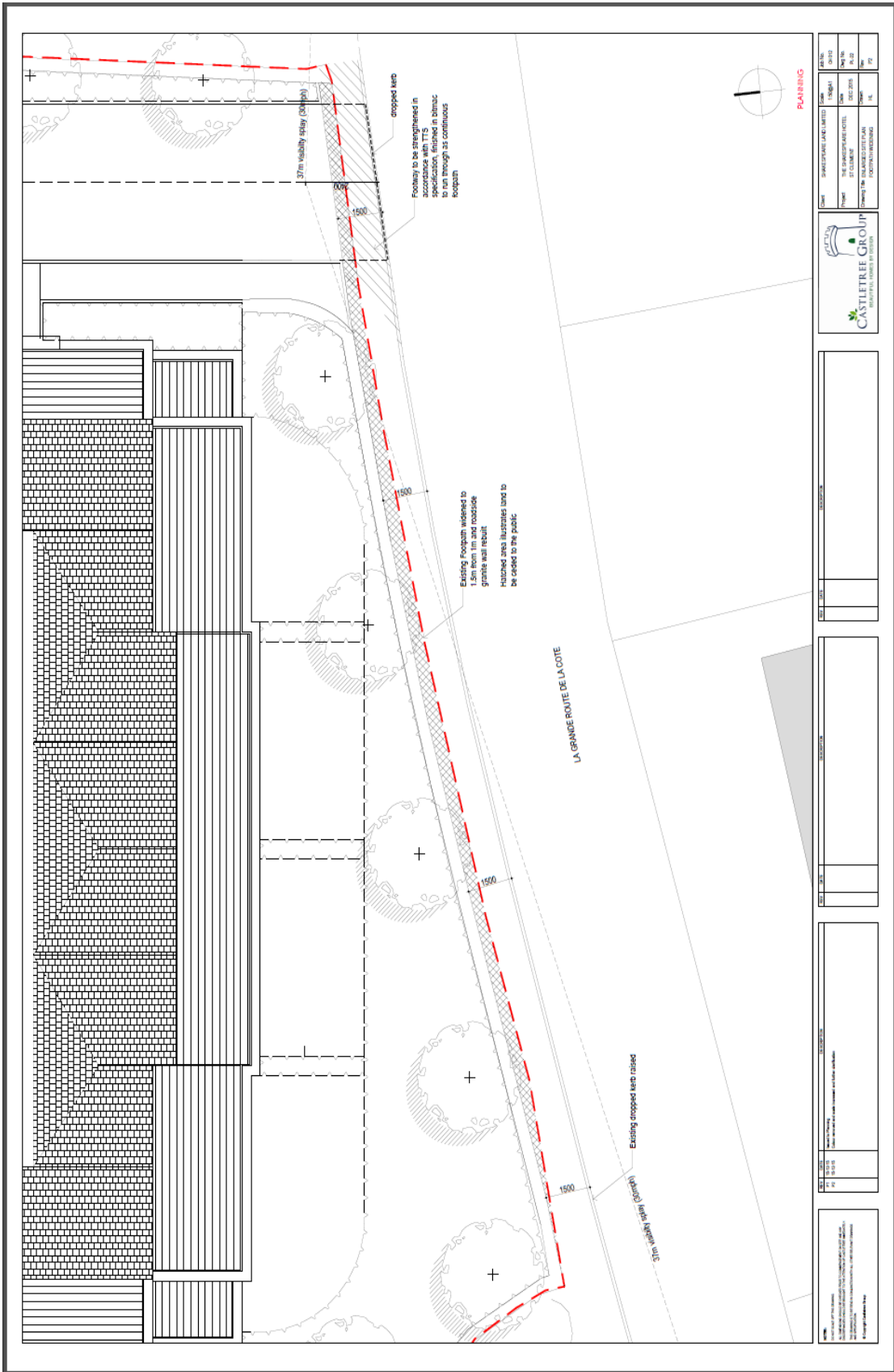

|   |  |   |  |
|---|--|---|--|
| <p>Project: LA GRANDE ROUTE DE LA COTE</p> <p>Client: SHAWMUTLAND (UK) LIMITED</p> <p>Contract No: 15/06/14</p> <p>Scale: 1:500</p> <p>Drawn: J. B. / 15/06/14</p> <p>Checked: J. B. / 15/06/14</p> <p>Approved: J. B. / 15/06/14</p> |  | <p>Project: LA GRANDE ROUTE DE LA COTE</p> <p>Client: SHAWMUTLAND (UK) LIMITED</p> <p>Contract No: 15/06/14</p> <p>Scale: 1:500</p> <p>Drawn: J. B. / 15/06/14</p> <p>Checked: J. B. / 15/06/14</p> <p>Approved: J. B. / 15/06/14</p> |  |
| <p>Project: LA GRANDE ROUTE DE LA COTE</p> <p>Client: SHAWMUTLAND (UK) LIMITED</p> <p>Contract No: 15/06/14</p> <p>Scale: 1:500</p> <p>Drawn: J. B. / 15/06/14</p> <p>Checked: J. B. / 15/06/14</p> <p>Approved: J. B. / 15/06/14</p> |  | <p>Project: LA GRANDE ROUTE DE LA COTE</p> <p>Client: SHAWMUTLAND (UK) LIMITED</p> <p>Contract No: 15/06/14</p> <p>Scale: 1:500</p> <p>Drawn: J. B. / 15/06/14</p> <p>Checked: J. B. / 15/06/14</p> <p>Approved: J. B. / 15/06/14</p> |  |
| <p>Project: LA GRANDE ROUTE DE LA COTE</p> <p>Client: SHAWMUTLAND (UK) LIMITED</p> <p>Contract No: 15/06/14</p> <p>Scale: 1:500</p> <p>Drawn: J. B. / 15/06/14</p> <p>Checked: J. B. / 15/06/14</p> <p>Approved: J. B. / 15/06/14</p> |  | <p>Project: LA GRANDE ROUTE DE LA COTE</p> <p>Client: SHAWMUTLAND (UK) LIMITED</p> <p>Contract No: 15/06/14</p> <p>Scale: 1:500</p> <p>Drawn: J. B. / 15/06/14</p> <p>Checked: J. B. / 15/06/14</p> <p>Approved: J. B. / 15/06/14</p> |  |
| <p>Project: LA GRANDE ROUTE DE LA COTE</p> <p>Client: SHAWMUTLAND (UK) LIMITED</p> <p>Contract No: 15/06/14</p> <p>Scale: 1:500</p> <p>Drawn: J. B. / 15/06/14</p> <p>Checked: J. B. / 15/06/14</p> <p>Approved: J. B. / 15/06/14</p> |  | <p>Project: LA GRANDE ROUTE DE LA COTE</p> <p>Client: SHAWMUTLAND (UK) LIMITED</p> <p>Contract No: 15/06/14</p> <p>Scale: 1:500</p> <p>Drawn: J. B. / 15/06/14</p> <p>Checked: J. B. / 15/06/14</p> <p>Approved: J. B. / 15/06/14</p> |  |