STATES OF JERSEY



LAND TRANSACTIONS UNDER STANDING ORDER 168(3) – JERSEY ELECTRICITY COMPANY SUB-STATION HOUSING SITES PHASE 2 – LEASES

Presented to the States on 22nd June 2011
by the Minister for Treasury and Resources

STATES GREFFE

REPORT

Decision(s): Under Standing Order 168(3) the Minister for Treasury and Resources hereby notifies the States that he has accepted the recommendation of the Property Holdings Department to agree to the following –

Land transaction –

- (1) To approve the granting of 99 year leases together with wayleaves to the Jersey Electricity Company Limited for the following sites –

Le Squez
Princess Place
Grasset Park
Brighton Close
Tower Road Maisonettes
Orchid Court.

- (2) To confirm the above decision after giving the States 15 working days' notice of the transaction, and to cause the transaction to be completed.

The Minister hereby authorises the Attorney General and the Greffier of the States to pass any contract which is required to be passed on behalf of the Public.

After the expiry of 15 days following presentation to the States the transaction may be concluded.

(Drawings attached at Appendix.)

Further information on this decision can be found on www.gov.je under Ministerial Decisions/Treasury and Resources/Property Holdings (reference MD-PH-2011-0072).

APPENDIX

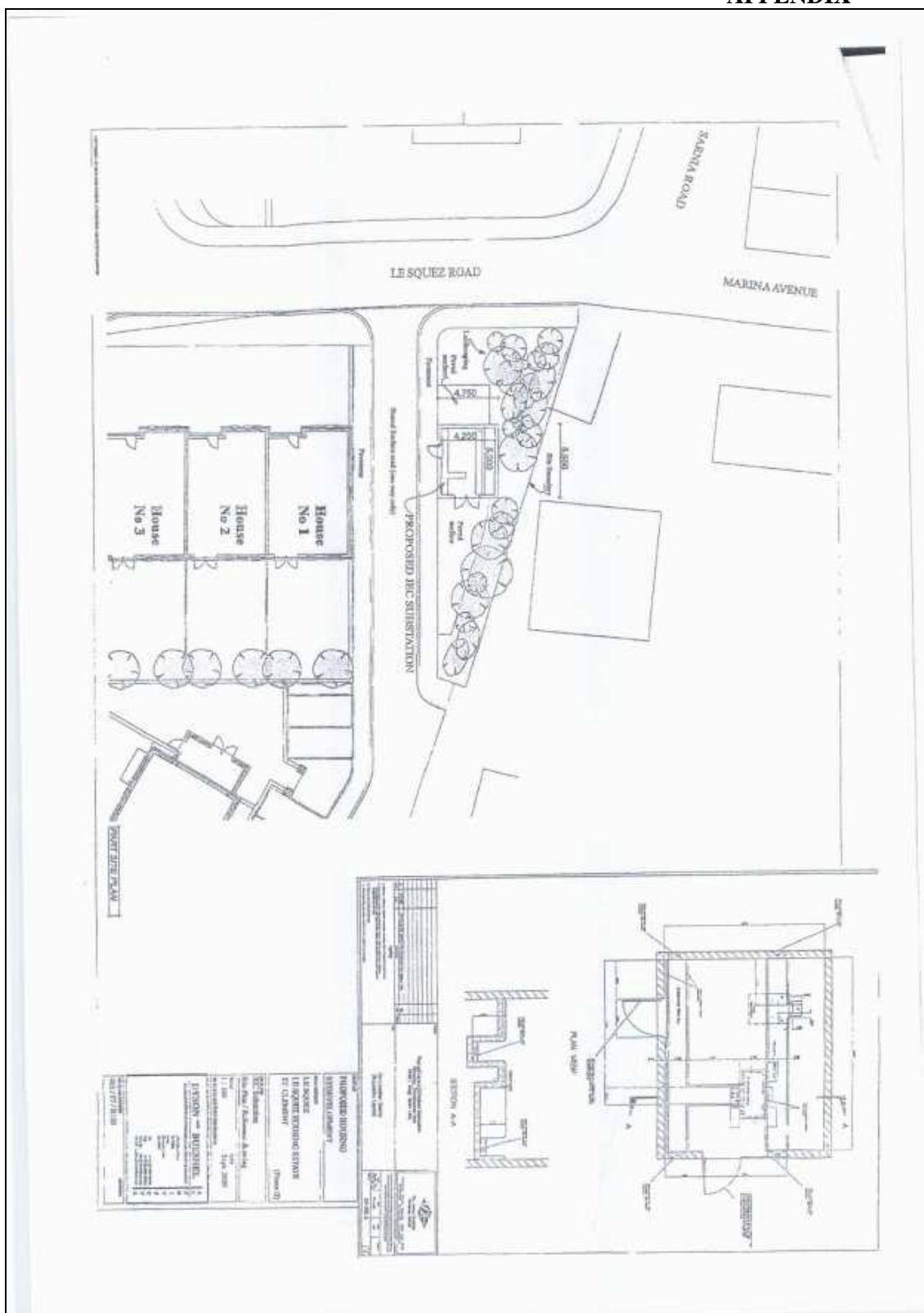



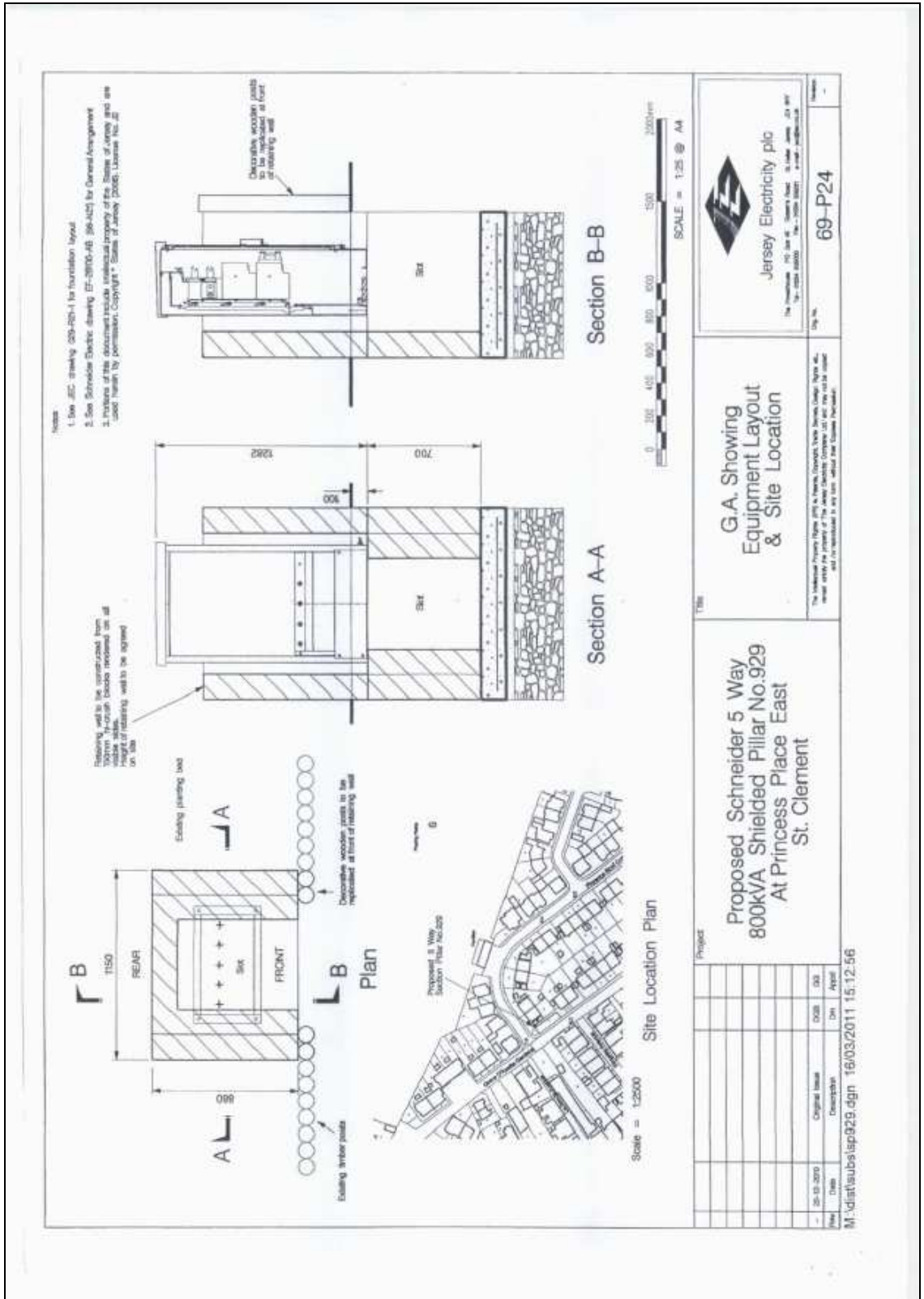

- Notes:
1. See JEC drawing 020-250-1 for foundation layout.
 2. See Schneider Electric drawing EF-3870-A3 (88-A23) for General Arrangement
 3. Portions of this document include intellectual property of the State of Jersey and are used herein by permission. Copyright © State of Jersey (2008). License No. 22

Retaining wall to be constructed from concrete. Section indicates an all height of retaining wall to be agreed on site.

Project	
Proposed Schneider 5 Way 800kVA Shielded Pillar No.929 At Princess Place East St. Clement	
Title: G.A. Showing Equipment Layout & Site Location	
 Jersey Electricity plc The Headquarters: 1st Floor 45, Queen's Road, St. Helier, Jersey, JE1 3BQ Tel: +354 699 8000 Fax: +354 699 8001 e-mail: info@jerseyelectricity.com	
Fig. No.	69-P24
Revision	-

The Intellectual Property Rights (IPR) in this document, which includes, but is not limited to, the design and drawings, are the property of Jersey Electricity plc and shall remain the property of Jersey Electricity plc and shall not be reproduced in any form without the written permission of Jersey Electricity plc.

No.	Date	Description	By	App'd
1	15-03-2010	Original Issue	DJB	DJB

M:\dlist\subs\sp929.dgn 16/03/2011 15:12:56

