

---

# STATES OF JERSEY



## LAND TRANSACTIONS UNDER STANDING ORDER 168(3) – BELLE VUE, ST. BRELADE – PROPOSED SALE OF MINOR PARCEL OF LAND CO-EXTENSIVE WITH 7 LE CLOS EMMA

---

Presented to the States on 29th October 2018  
by the Minister for Infrastructure

---

STATES GREFFE

## REPORT

**Decision(s):** Under Standing Order 168(3), the Minister for Infrastructure hereby notifies the States that he has accepted the recommendation of Jersey Property Holdings to agree to the following –

### **Land transaction –**

The sale by the Public to the owner of 7 Le Clos Emma, Belle Vue, St. Brelade, of a small parcel of land co-extensive with the dwelling – as per the in-principle terms set out in the report accompanying the Ministerial Decision.

The Minister hereby authorises, as applicable, the Attorney General and the Greffier of the States to pass any contract which is required to be passed on behalf of the Public; and the Director of Property Holdings to conclude any contract which is required to be concluded on behalf of the Public.

After the expiry of 15 days following presentation to the States the transaction may be concluded.

*(Drawings attached at Appendix.)*

*Further information on this decision may be viewed in due course at:*

*<https://www.gov.je/government/planningperformance/pages/ministerialdecisions.aspx>  
under Ministerial Decision reference MD-PH-2018-0052.*

APPENDIX

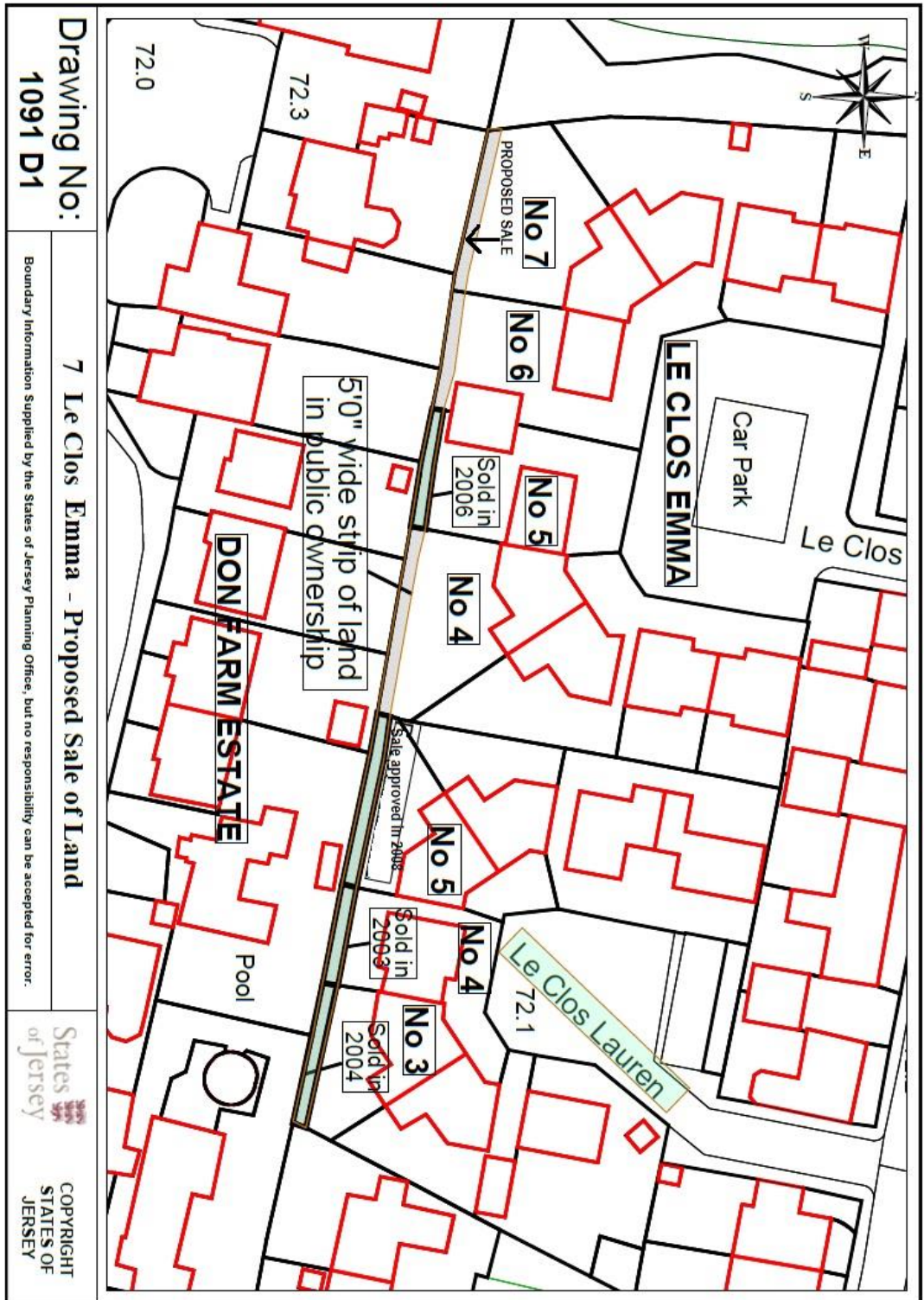

Drawing No:  
1091 D1

7 Le Clos Emma - Proposed Sale of Land

Boundary Information Supplied by the States of Jersey Planning Office, but no responsibility can be accepted for error.

States of Jersey

COPYRIGHT  
STATES OF  
JERSEY

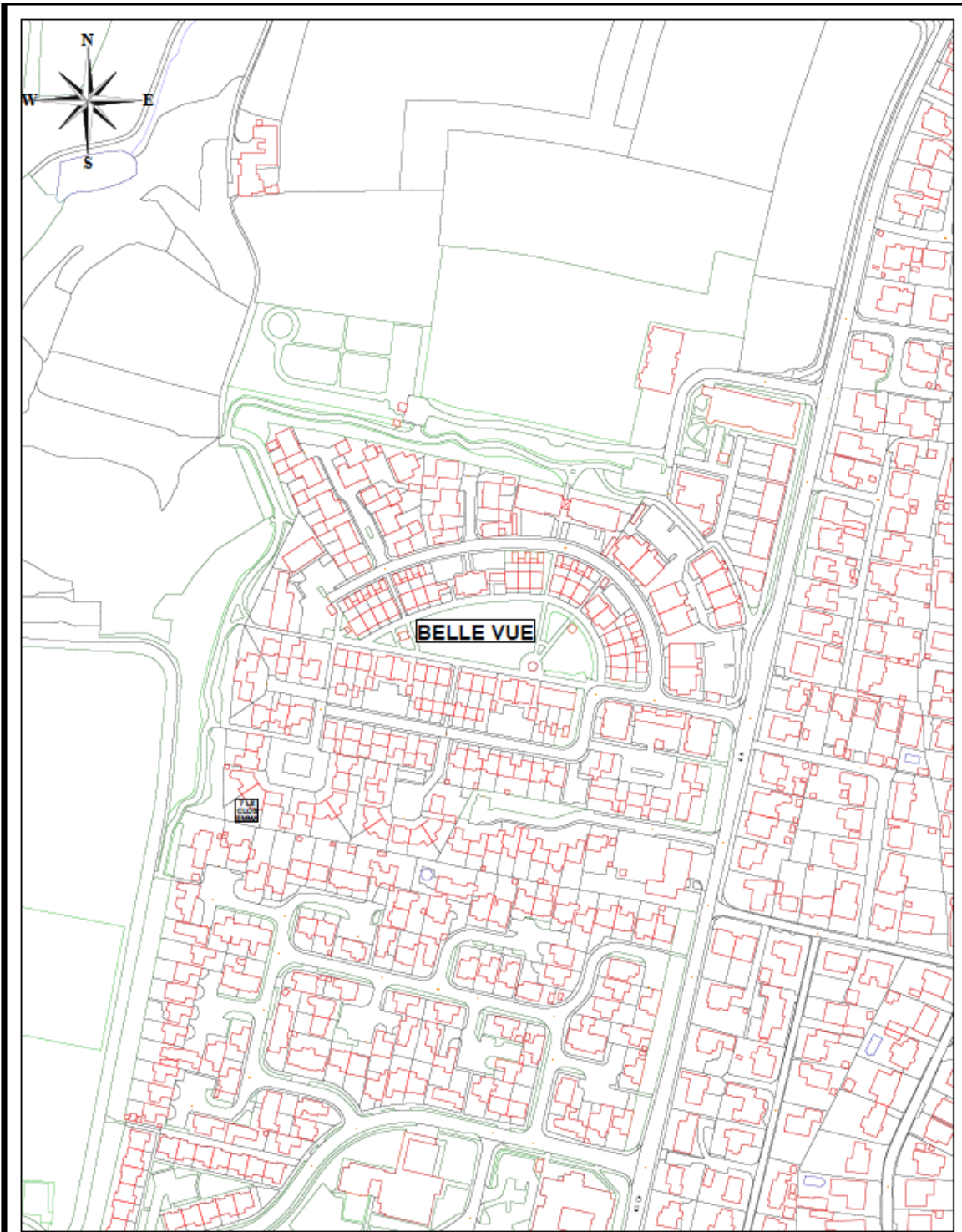

Belle Vue, St Brelade

Drawing No: 1091 D2

Boundary Information Supplied by the States of Jersey Planning Office, but no responsibility can be accepted for error.



COPYRIGHT  
STATES OF JERSEY