STATES OF JERSEY



LAND TRANSACTIONS UNDER STANDING ORDER 168(3) – A11 LA VALLÉE DE ST. PIERRE, ST. LAWRENCE – ACQUISITION OF LAND

Presented to the States on 31st December 2010
by the Minister for Treasury and Resources

STATES GREFFE

REPORT

Decision(s): Under Standing Order 168(3) the Minister for Treasury and Resources hereby notifies the States that he has accepted the recommendation of the Property Holdings Department to agree to the following –

Land transaction –

To approve the acquisition of two areas of land forming part of the road improvement requirements in relation to La Providence Housing Scheme.

After the expiry of 15 days following presentation to the States the transaction may be concluded.

(Drawing attached at Appendix)

Further information on this decision can be found on www.gov.je under Ministerial Decisions/Treasury and Resources/Property Holdings (reference MD-PH-2010-0129).

APPENDIX

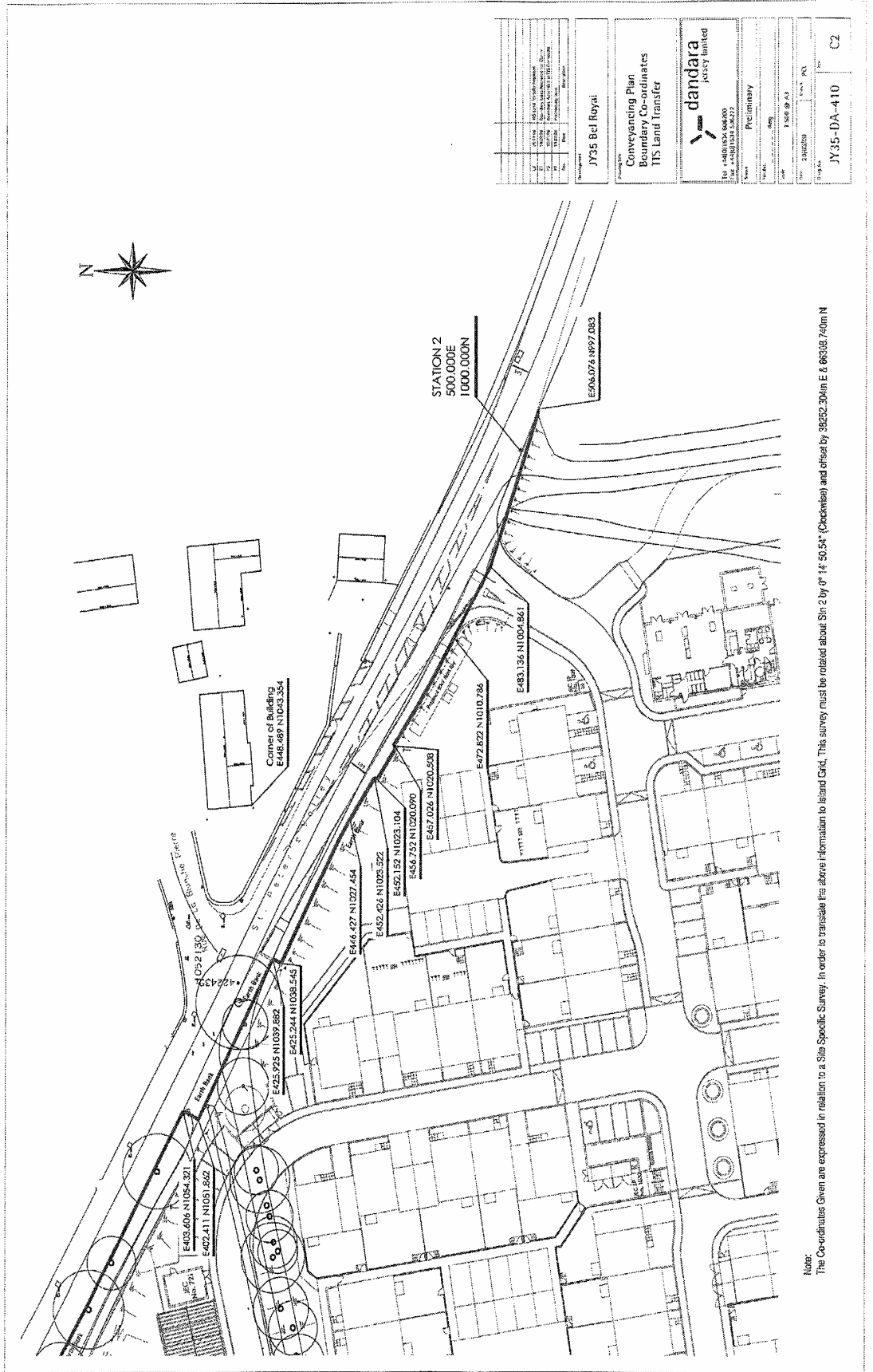

<p>JY35 Bel Royal</p> <p>Conveyancing Plan Boundary Co-ordinates TIS Land Transfer</p>	
<p>dandara JCSY Limited</p> <p>No. 1401834 04000 Tel. +65 6354 3522 Fax. +65 6354 3527</p>	
<p>Preliminary</p>	
<p>Scale: 1:500 @ A3</p>	<p>Date: 28/03/20</p>
<p>Project No: JY35-DA-410</p>	<p>Rev: C2</p>

Note:
The Co-ordinates Given are expressed in relation to a Site Specific Survey. In order to translate the above information to Island Grid, This survey must be related about S_{in} 2 by 4° 14' 50.54" (Clockwise) and offset by 38252.304m E & 86338.740m N