

STATES OF JERSEY



GORSELAND, LA RUE DE LA CORBIERE, ST. BRELADE: PROPOSED PURCHASE

**Lodged au Greffe on 24th June 2003
by the Home Affairs Committee**

STATES GREFFE

PROPOSITION

THE STATES are asked to decide whether they are of opinion –

to refer to their Act dated 5th November 2002 in which they approved the purchase of the property known as Ruxley, Longueville Road, St. Saviour as a replacement residential property to Gorseland, La Rue de la Corbière, St. Brelade, and–

- (a) to authorise the sale to Mr. Colin Ridgway Goss and Mrs. Mary Ann Goss, of the property known as Gorseland, La Rue de la Corbière, St. Brelade administered by the Home Affairs Committee and the access track adjoining Gorseland, La Rue de la Corbière, St. Brelade administered by the Environment and Public Services Committee (shown on Drawing No. 1474/03/58 for illustration purposes only), for the sum of £575,000 (five hundred and seventy-five thousand pounds) with each party responsible for their own legal fees;
- (b) to authorise the Attorney General and the Greffier of the States to pass, on behalf of the Public, any contracts which might be found necessary to pass in connection with the said property referred to in paragraph (a) and any interest therein;
- (c) to authorise the Treasurer of the States to receive any payment to the Public as it becomes due;
- (d) to authorise the payment or discharge of expenses to be incurred in connection with the sale of the said property and all interests therein from the Planning and Environment vote of credit 'Acquisition of Land – Major Reserve' (Vote C0904).

HOME AFFAIRS COMMITTEE

- Notes: 1. The Environment and Public Services Committee supports the proposition.
2. The Finance and Economics Committee's comments are to follow.

REPORT

The States at their meeting of 5th November 2002 adopted proposition P.178/2002 of the Home Affairs Committee to purchase the property known as Ruxley, Longueville Road, St. Saviour as a replacement residential property to Gorseland, La Rue de la Corbière, St. Brelade for the purpose of providing residential accommodation for a serviceman seconded from the U.K. to the Jersey Field Squadron and his family. It was explained to the States that there is a commitment to provide suitable accommodation for up to 4 service personnel.

The property was originally acquired in 1993 by the Public on behalf of the Environment and Public Services Committee (formerly the Planning and Environment Committee) as part of the purchase of 120 vergées of heathland which is now managed by the Environmental Services Unit for the benefit of the Public. The property was later transferred to the Home Affairs Committee in 1996 but the access track remained with the Environment and Public Services Committee. The suitability of the Gorseland was questioned in 2002 due to the unnecessarily large size, remote location and high maintenance costs. The States were advised by the Department of Property Services that the demise of Gorseland should achieve an open market price in the region of £575,000.

The property was placed on the open market through a reputable Estate Agent and marketed for sale in the usual manner. Terms and conditions have now been agreed, subject to States approval, with Mr. Colin Ridgway Goss and Mrs. Mary Ann Goss for the sale of the freehold of the property known as Gorseland, La Rue de la Corbière St. Brelade and the access track (both illustrated on the Site Plan/Drawing No. 1474/03/58) for the sum of £575,000 to include carpets, curtains and light fittings. The States are asked to note that Mr. and Mrs. Goss' offer is not subject to the sale of their existing property nor is it subject to survey. The Department of Property Services fully supports the sale of this property as it provides a saving to the Public purse.

It is proposed that the proceeds from the sale of Gorseland will be returned to the Capital Fund in accordance with the Public Finance (Administration) (Jersey) Law 1967.

It has been agreed that each party is to pay their own legal costs in relation to this transaction and there are no additional manpower implications for the States arising from this proposition.

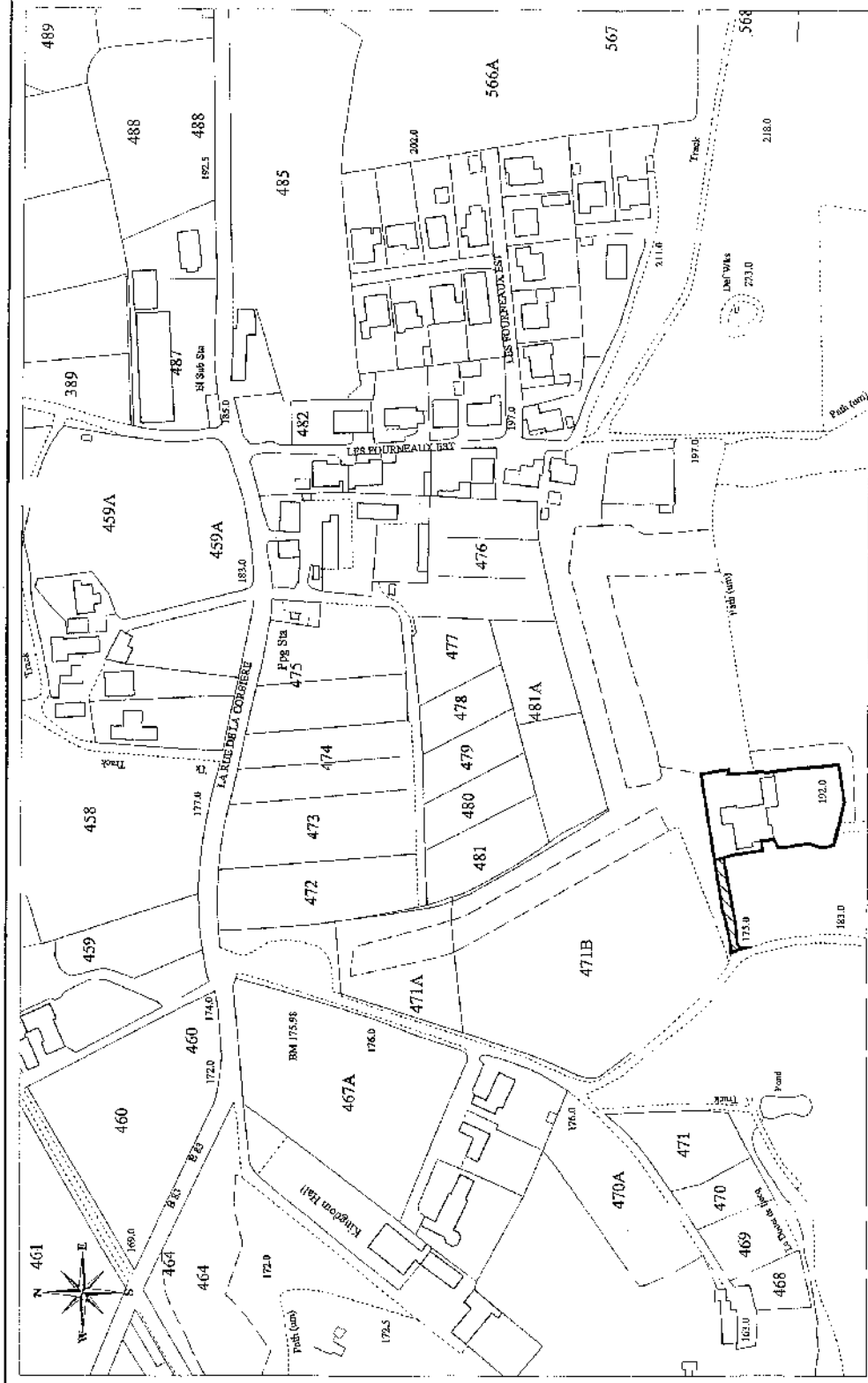

Drawing No: Location Plan - Gorseland, La Rue de la Corbriere, St Brelade
1474/03/58

Boundary Information Supplied by the States of Jersey Planning Office, but no responsibility can be accepted for error.



COPYRIGHT
 PLANNING & ENVIRONMENT
 COMMITTEE

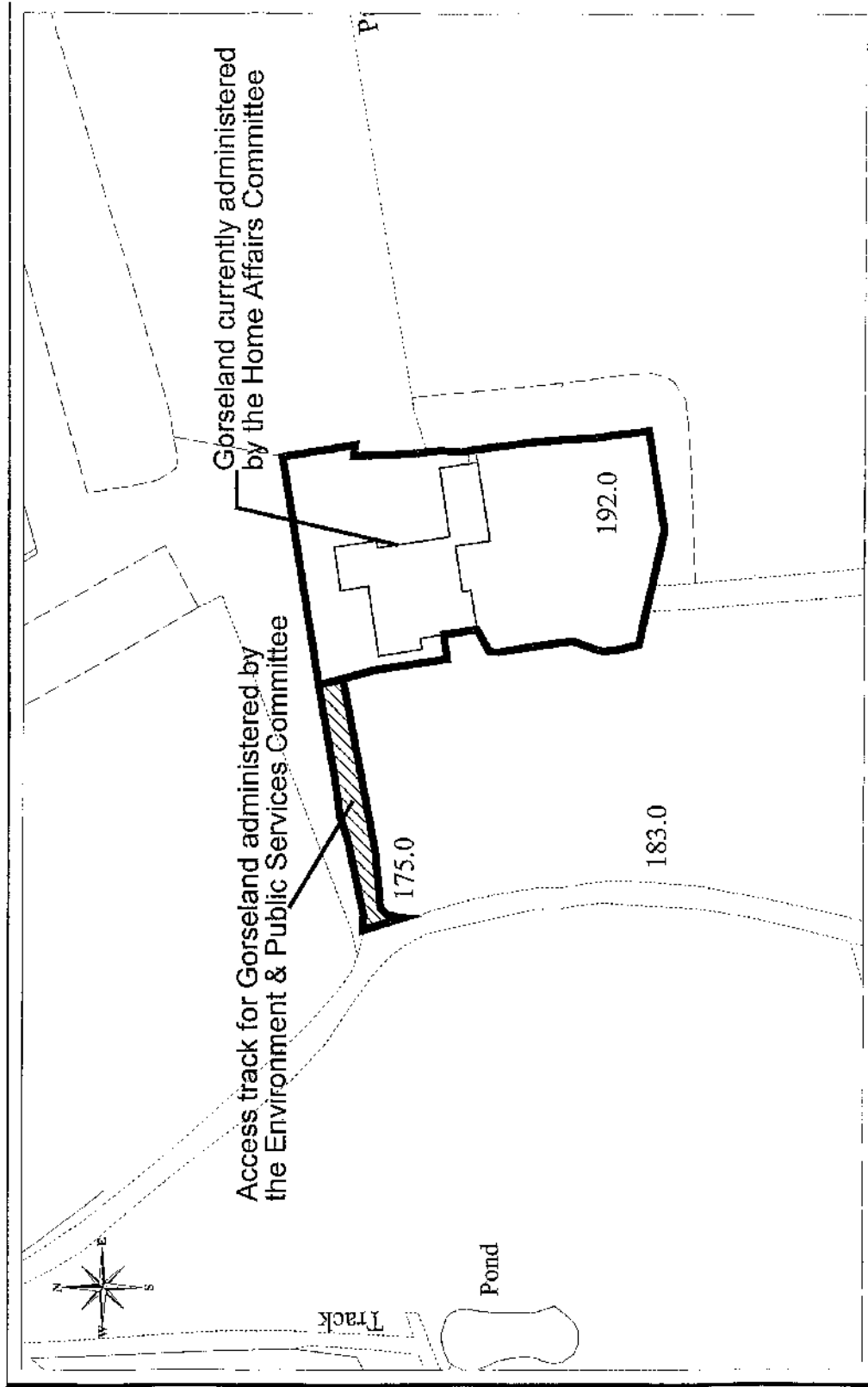

Drawing No: Site Plan Illustrating Extent of Land to be Sold - Gorseland

1474/03/58

Boundary Information Supplied by the States of Jersey Planning Office, but no responsibility can be accepted for error.



COPYRIGHT
PLANNING & ENVIRONMENT
COMMITTEE