

STATES OF JERSEY

r

MAISON ST. LOUIS OBSERVATORY, HIGHLANDS LANE, ST. SAVIOUR AND LA MOYE WEATHER RADAR STATION, LA FOSSE VOERIN, ST. BRELADE: TRANSFER OF ADMINISTRATION

**Lodged au Greffe on 23rd November 2004
by the Harbours and Airport Committee**

STATES GREFFE

PROPOSITION

THE STATES are asked to decide whether they are of opinion –

- (a) to approve the transfer of administration from the Harbours and Airport Committee to the Environment and Public Services Committee of the following properties –
 - (i) the observatory, outbuildings, land and appurtenances known as Maison St. Louis St. Saviour, as shown on Drawing No. 558/04/73, and
 - (ii) the La Moye Weather Radar Station, St. Brelade and land dependent thereto, as shown on Drawing No. 556/04/74; and
- (b) to authorise the Greffier of the States to sign the said drawings on behalf of the States.

HARBOURS AND AIRPORT COMMITTEE

Note: The Environment and Public Services Committee supports the proposition accepting that the transfer of these properties is part of the overall transfer of responsibilities for the Meteorology Service from the Harbours and Airport Committee. The maintenance costs can be met within existing cash limits and through income from the services provided.

REPORT

Maison St. Louis Observatory has been operated continuously as a weather recording station since 1894. It was purchased by the Public on 25th January 1974 and continues to be used as an observatory.

La Moye Weather Radar Station is sited on land purchased in 1989 and was commissioned in 1991.

In 2004, the Jersey Meteorological Department transferred from the Harbours and Airport Committee to the Environment and Public Services Committee.

Maison St. Louis and La Moye Weather Radar Station continue to be operated by the Meteorological Department and it is therefore proposed that the administration is transferred to the Environment and Public Services Committee.

There no other financial implications or manpower implications resulting from the proposed transfer of administration.

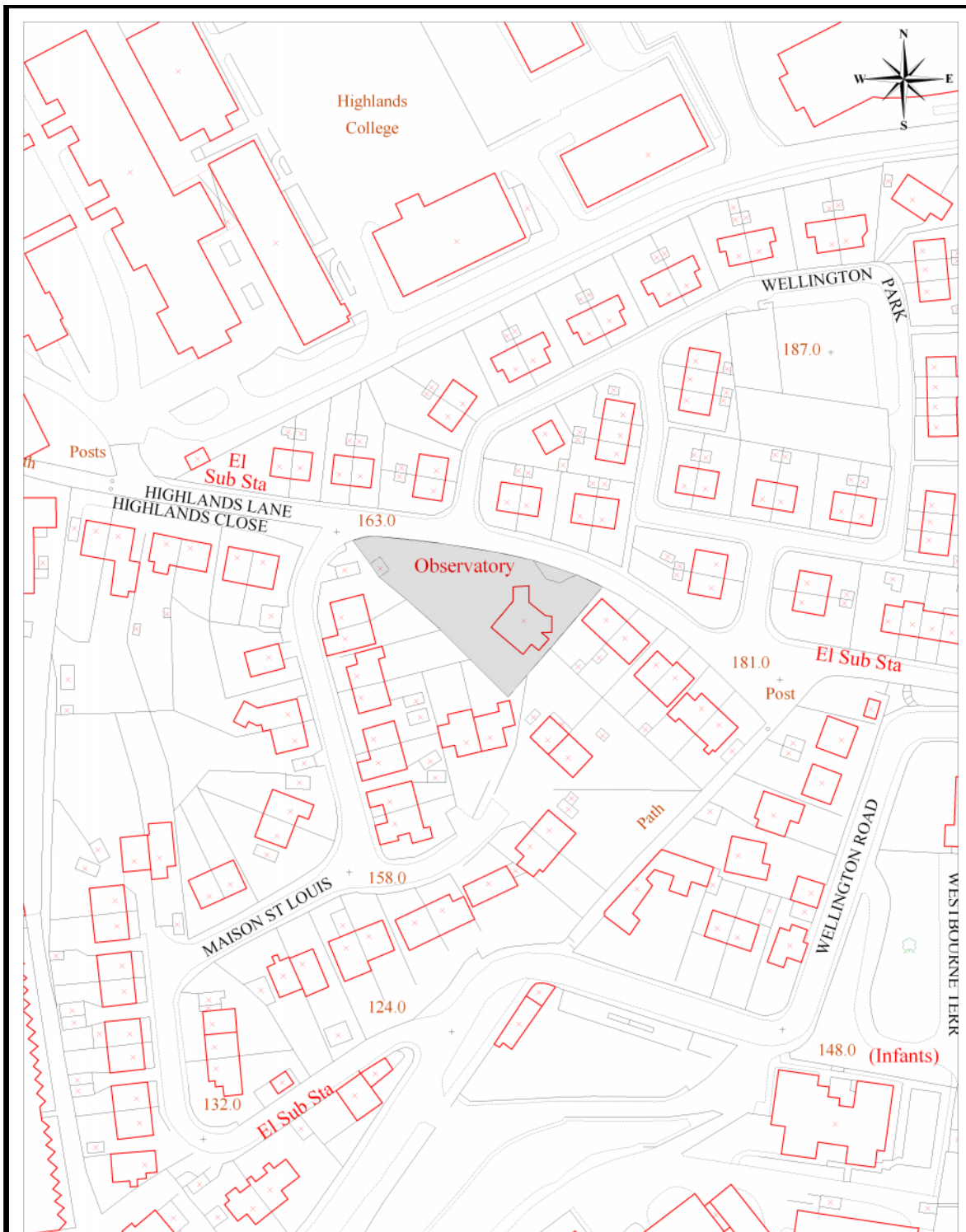

Maison St Louis Observatory, St S

Drawing No: 558/04/73

Boundary Information Supplied by the States of Jersey Planning Office, but no responsibility can be accepted for error.



**COPYRIGHT
PLANNING & ENVIRONMENT
COMMITTEE**

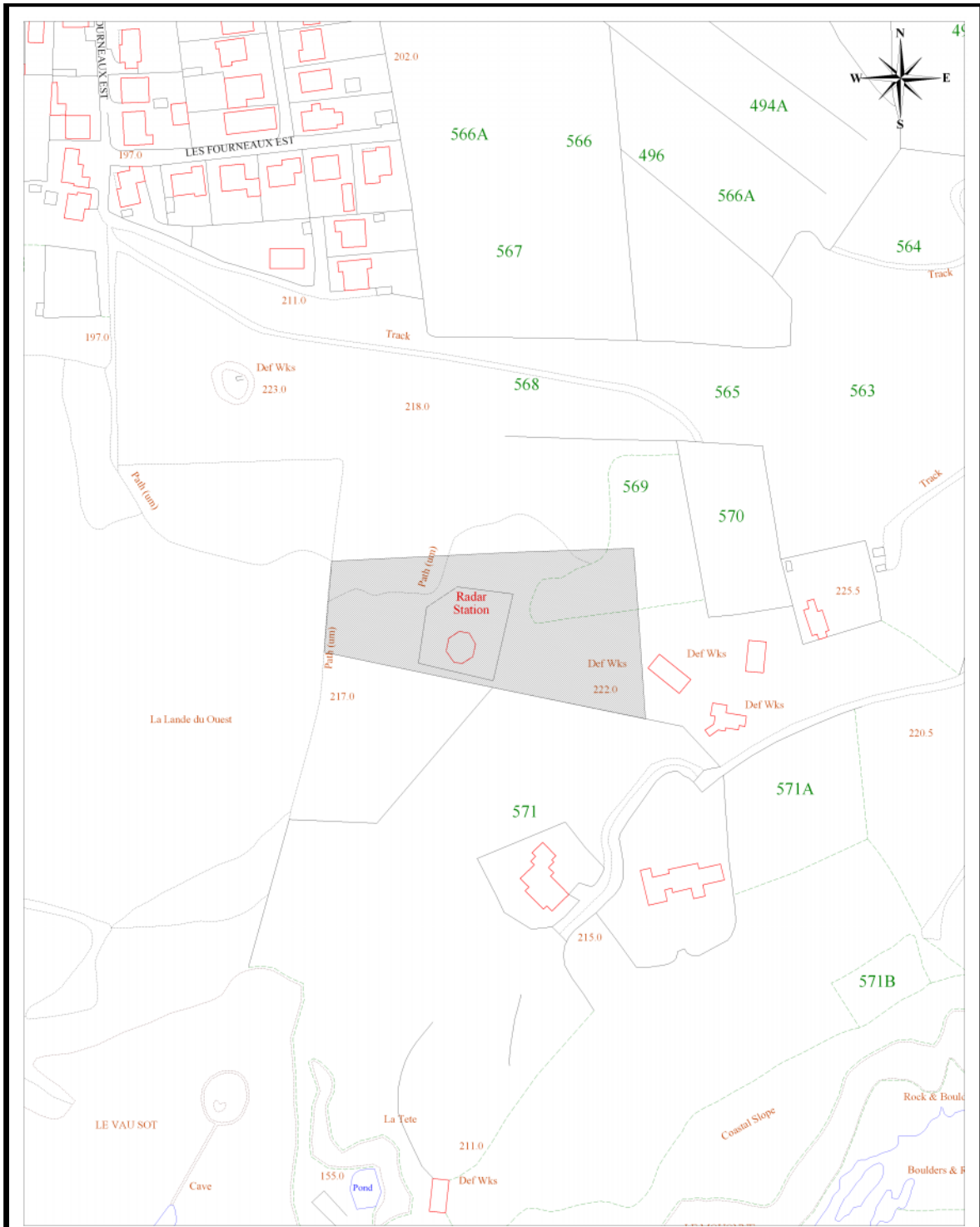

La Moye Weather Radar Station, St B

Drawing No: 556/04/74

Boundary Information Supplied by the States of Jersey Planning Office, but no responsibility can be accepted for error.



**COPYRIGHT
PLANNING & ENVIRONMENT
COMMITTEE**